

# AIMEX 2011

Asia Pacific's International Mining Exhibition  
6 - 9 September 2011  
Sydney Showground, Sydney Olympic Park

www.aimex.com.au

Contact: Chris Ghosh  
Tel: (02) 9422 2518  
E: [chris.ghosh@reedexhibitions.com.au](mailto:chris.ghosh@reedexhibitions.com.au)

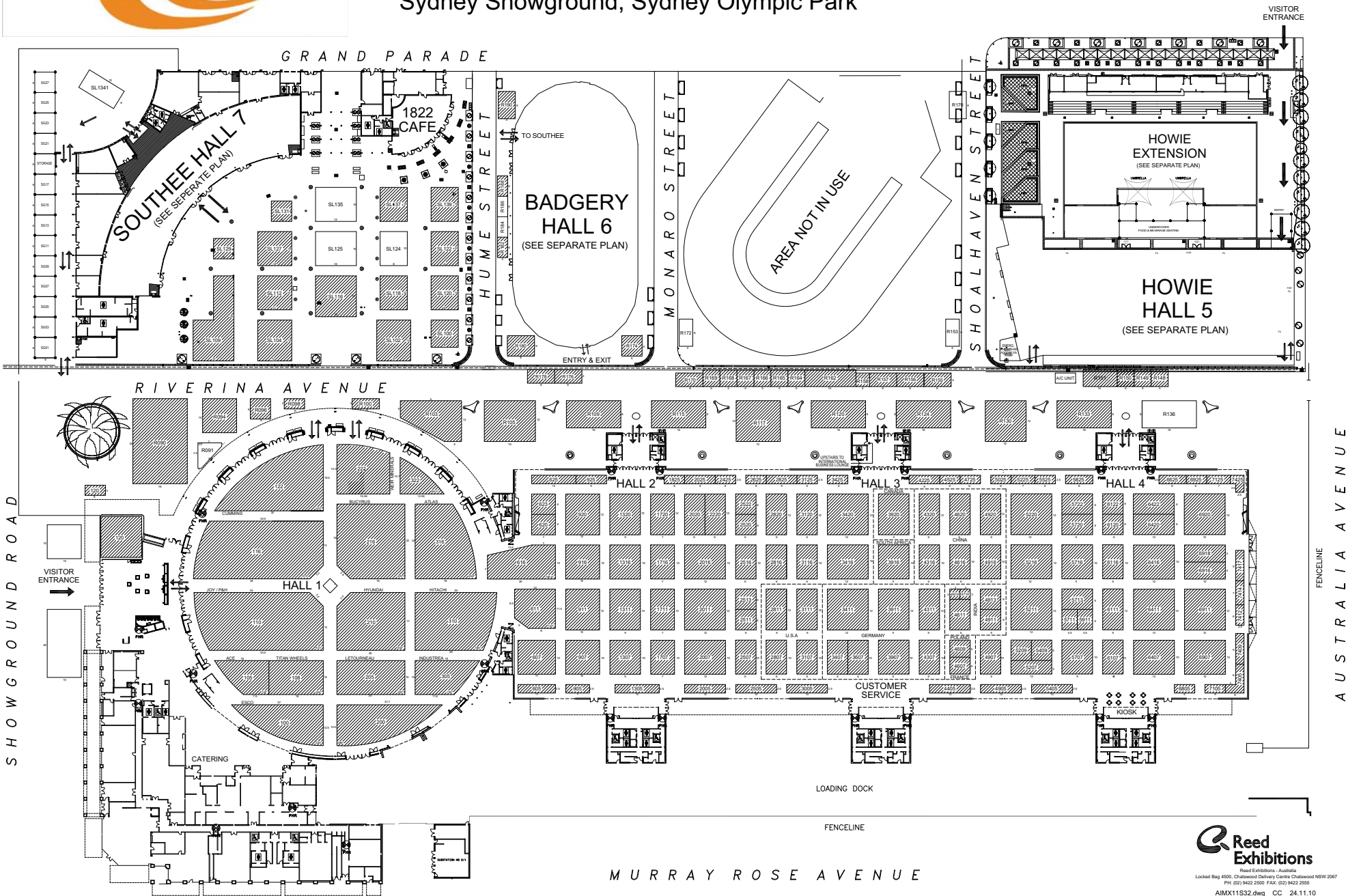



# AIMEX 2011

Asia Pacific's International Mining Exhibition  
 Sydney Showground, Sydney Olympic Park  
 6 - 9 September 2011

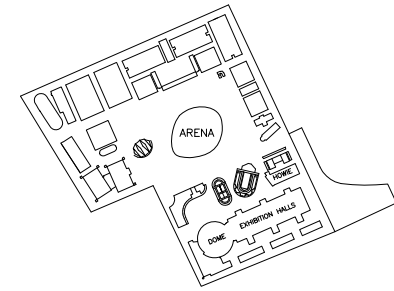

KEYPLAN

MEZZANINE LEVEL

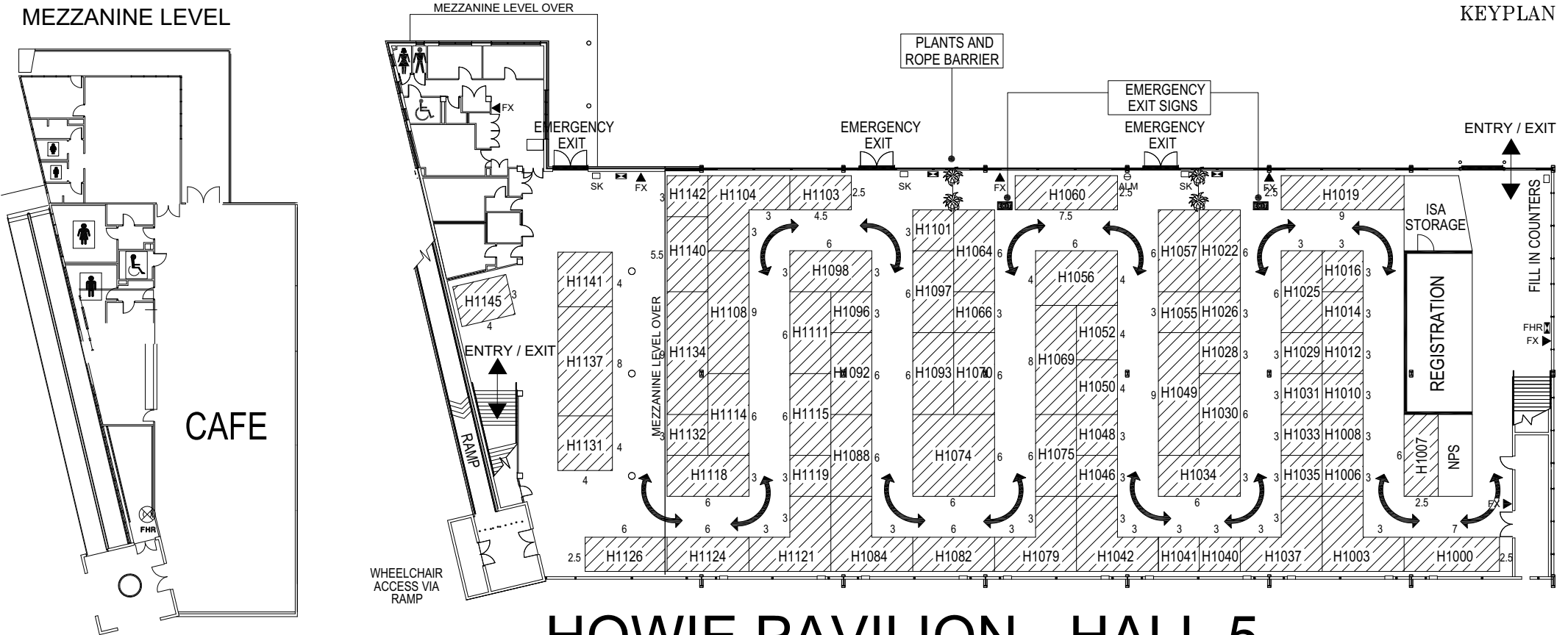

## HOWIE PAVILION - HALL 5

[www.aimex.reedexhibitions.com.au](http://www.aimex.reedexhibitions.com.au)

Contact: Chris Ghosh  
 Tel: (02) 9422 2518  
 email: [chris.ghosh@reedexhibitions.com.au](mailto:chris.ghosh@reedexhibitions.com.au)

- FLOORPLAN SUBJECT TO CHANGE -

TO HALL 4



**LEGEND**

- COLUMN
- MEZZANINE SUPPORT COLUMN
- POT PLANT
- ROPE BARRIER



Reed Exhibitions - Australia  
 Locked Bag 4500, Chatswood Delivery Centre Chatswood NSW 2067  
 PH: (02) 9422 2500 FAX: (02) 9422 2555  
 AIMX11S17\_HOWIE.dwg CC 09.11.10



# AIMEX 2011

Asia Pacific's International Mining Exhibition  
 6 - 9 September 2011  
 Sydney Showground, Sydney Olympic Park



Reed Exhibitions - Australia  
 Locked Bag 4500, Chatswood Delivery Centre Chatswood NSW 2067  
 PH: (02) 9422 2500 FAX: (02) 9422 2555

AIMX11S1\_HOWIE EXTENSION.dwg CC 24.11.10

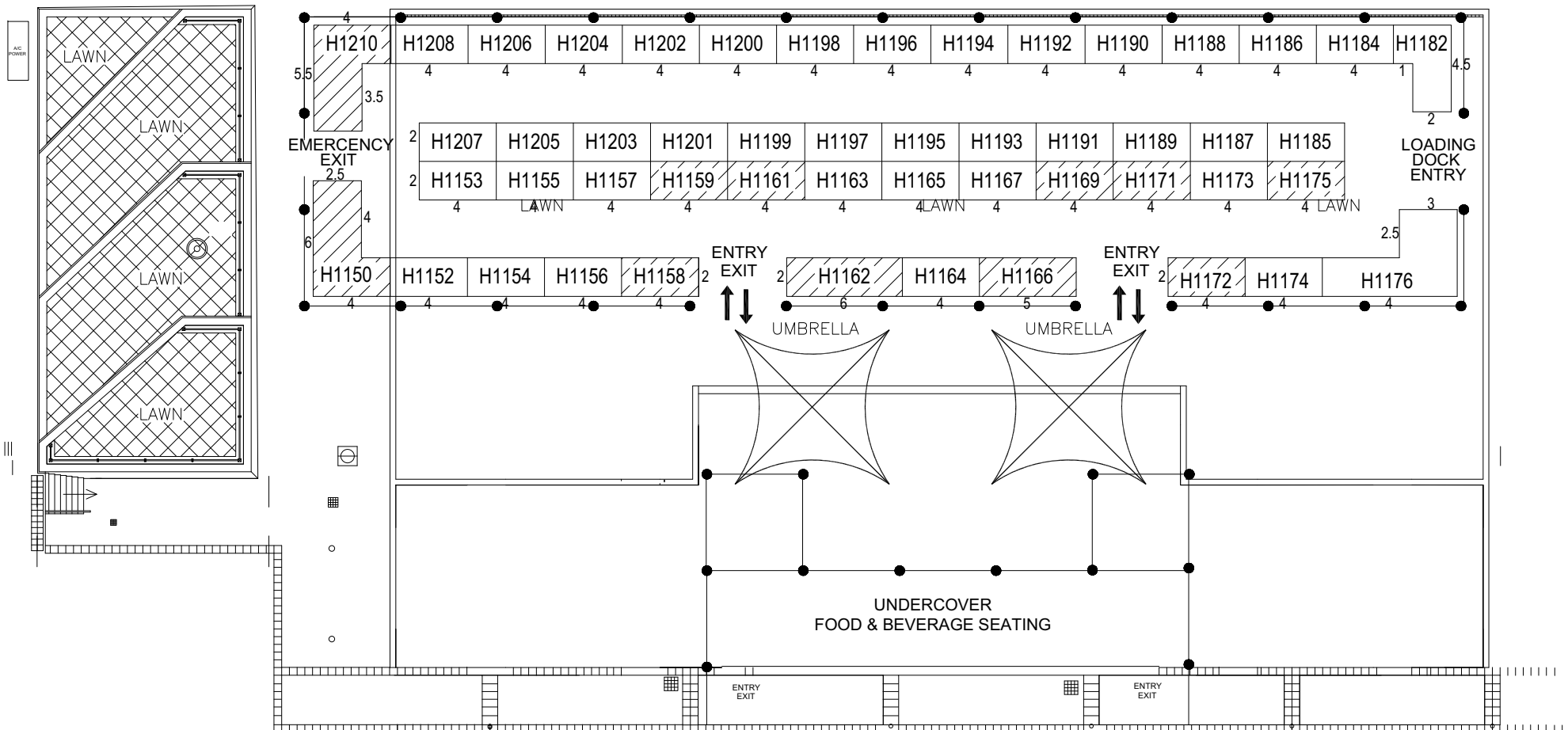

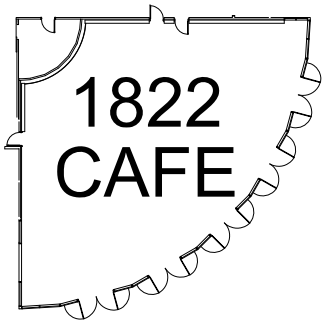

TO SOUTHEE PAVILION



H U M E S T R E E T

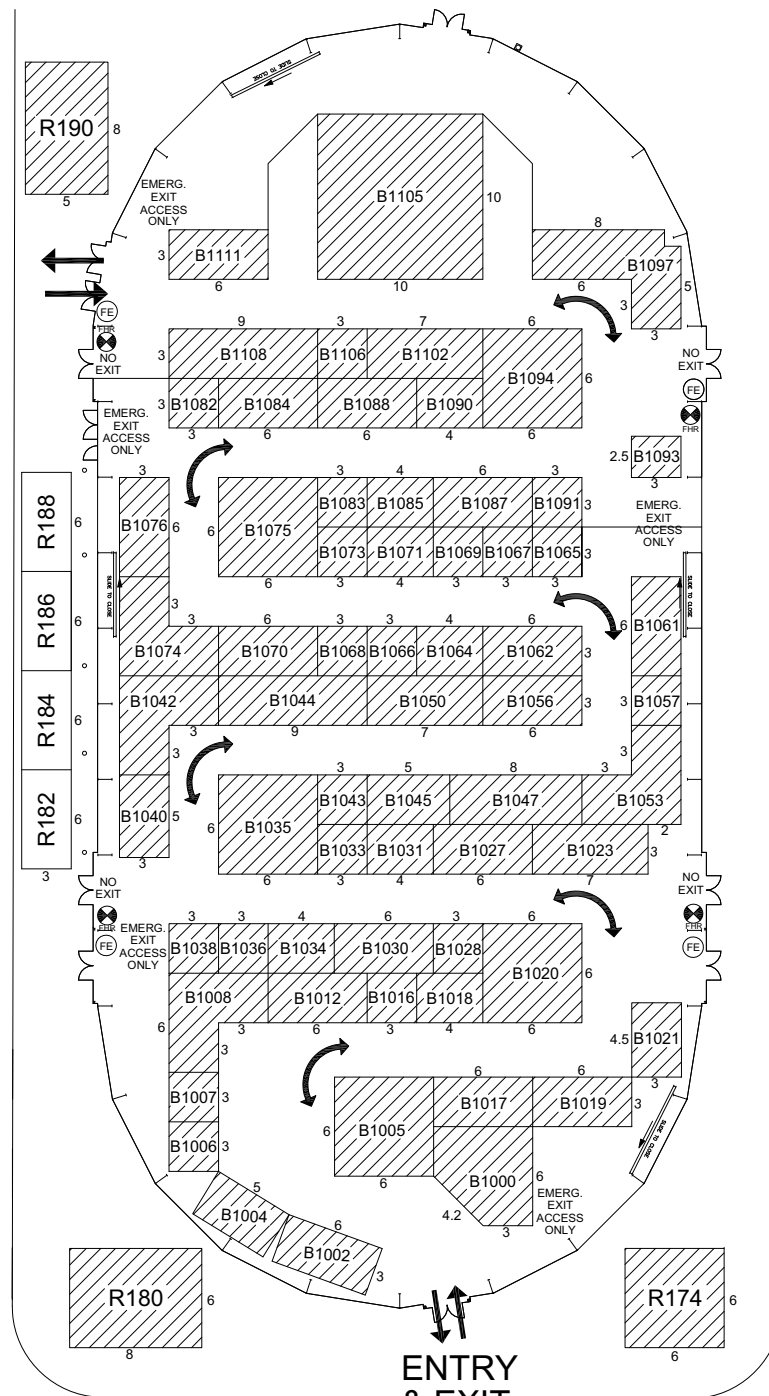

ENTRY & EXIT

TO HALLS 1 - 4

R I V E R I N A A V E N U E



M O N A R O S T R E E T



# AIMEX 2011

Asia Pacific's International Mining Exhibition  
 Sydney Showground, Sydney Olympic Park  
 6 - 9 September 2011

## BADGERY PAVILION - HALL 6

- FLOORPLAN SUBJECT TO CHANGE -

[www.aimex.reedexhibitions.com.au](http://www.aimex.reedexhibitions.com.au)

Contact: Chris Ghosh  
 Tel: (02) 9422 2518  
 email: [chris.ghosh@reedexhibitions.com.au](mailto:chris.ghosh@reedexhibitions.com.au)

Or

Contact: Soren Norgaard  
 Tel: (02) 9422 2563  
 email: [soren.norgaard@reedexhibitions.com.au](mailto:soren.norgaard@reedexhibitions.com.au)



Reed Exhibitions - Australia  
 Locked Bag 4500, Chatswood Delivery Centre Chatswood NSW 2067  
 PH: (02) 9422 2500 FAX: (02) 9422 2555  
 AIMX11S13\_BADGERY.dwg CC 09.11.10



# AIMEX 2011

Asia Pacific's International Mining Exhibition  
Sydney Showground, Sydney Olympic Park  
6 - 9 September 2011

## SOUTHEE PAVILION - HALL 7

- FLOORPLAN SUBJECT TO CHANGE -

[www.aimex.reedexhibitions.com.au](http://www.aimex.reedexhibitions.com.au)

Contact: Chris Ghosh  
Tel: (02) 9422 2518  
email: [chris.ghosh@reedexhibitions.com.au](mailto:chris.ghosh@reedexhibitions.com.au)

Or

Contact: Soren Norgaard  
Tel: (02) 9422 2563  
email: [soren.norgaard@reedexhibitions.com.au](mailto:soren.norgaard@reedexhibitions.com.au)



Reed Exhibitions - Australia  
Locked Bag 4500, Chatswood Delivery Centre Chatswood NSW 2067  
PH: (02) 9422 2500 FAX: (02) 9422 2555  
AIMX11S12\_SOUTHEE.dwg CC 06.12.10

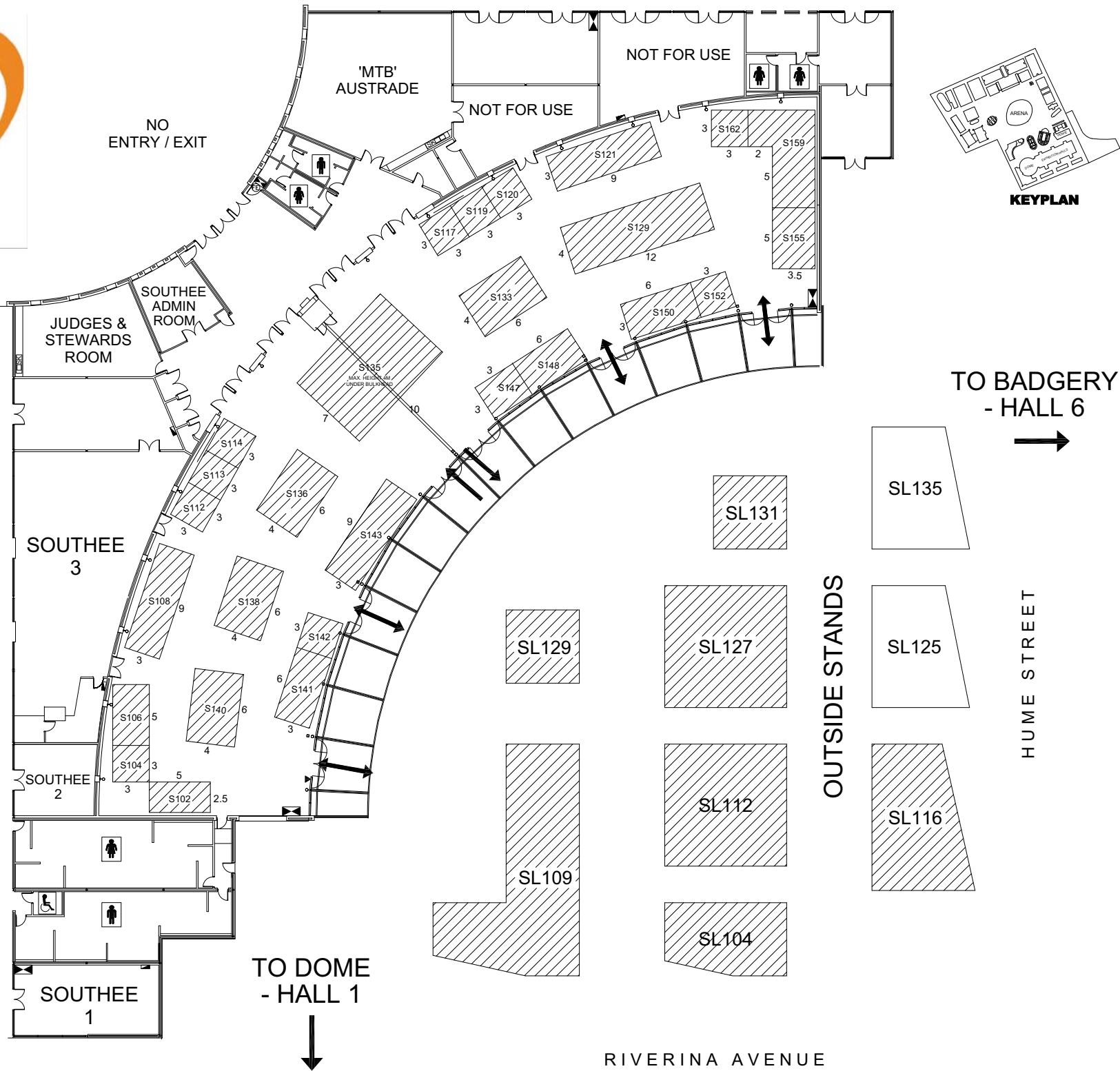

RIVERINA AVENUE